

WIFI Module Instruction Manual

1. ARV WIFI Module Configuration

1.1 APP Download

Mobile terminal scan the following dimensional code to download APP, or search "AC Freedom" in APPSTORE and Google store.

Note: If the current version of your APP is not version 2.0 or higher, please update the APP before proceeding with device network configuration.



1.2 WIFI Module Installation

a) Connect the WIFI module communication wire to WIFI interfaces of main PCB, as shown below:

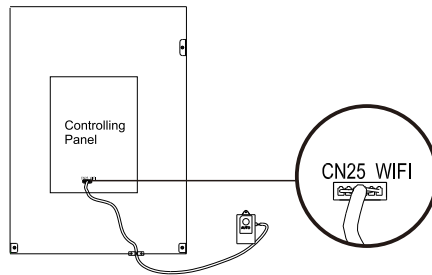

b) The WIFI module should be placed in the return air or some other place in WIFI area. (customers buy the wireless router)

1.3 APP Configuration

- Device reset: Confirm after selecting "OPTIONS" in the "Menu" of the wired controller, select "WLAN CONFIG" and confirm, and confirm again after a pop-up box appears;
- Connect the mobile phone to the wireless network, open the APP, click "Add Device", select "Heat Pump", and start adding;
- Connect the mobile phone WLAN to "AC-xxxx" (xxxx consists of letters and numbers, which are randomly generated), and return to the APP;

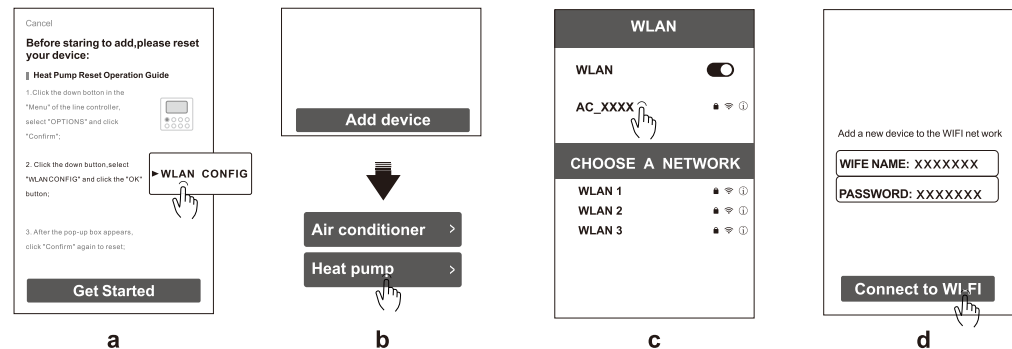

d) Enter the wireless network password and click "Connect to Wi-Fi" (Android and IOS phones have different operation sequences in steps c and d, the specific situation is subject to the APP display)

Note: If the configuration fails or you change the password of wireless router, you need to reset the WIFI module to reconnect: repeat the steps above for APP configuration.

2. AC Management

2.1 Remote control with wireless router

Once the wireless router is connected to the internet, activating the GPRS on the mobile terminal will enable the remote control of the devices.

2.2 For other instructions, please refer to "HELP" in APP.

3. Troubleshooting

If unable to properly configured or connect the WIFI box:

- Check whether the Wi-Fi module is connected correctly. The confirmation method is as follows: If the Wi-Fi module is connected correctly, there will be an icon , in the upper right corner of the screen of the wired controller; if the Wi-Fi module is not properly connected, there will be no icon in the upper right corner of the screen of the wired controller.
- Check whether the Wi-Fi module is reset successfully. The confirmation method is as follows: After the Wi-Fi module is successfully reset, a hotspot named "AC-xxxx" can be found in the WLAN list of the mobile phone, If the problem cannot be solved, please contact after sales person.

4. Technical Parameters

- Working temperature: 0~50°C ;
- Working environment humidity: 20~90%RH ;
- Dimensions: 78 × 52 × 15.5mm
- Configuration cable wire length: 1500mm

